

Accessory for LSLxxxx spot light

ZSLG002

Part Number

Technical Data

Mechanical Data

Housing Material	Plastic, PMMA
Optic Cover	Plastic, PMMA



- **Ø 8 mm coaxial attachment**
- **Suitable for all lenses with a Ø 8 mm inline illumination aperture**
- **Usable and exchangeable with all LSL spot light configurations**

The ZSLG002 is an exchangeable illumination accessory that converts any LSL spot light into a powerful coaxial illumination for use with telecentric and macro lenses that have an illumination aperture and a beam guide.

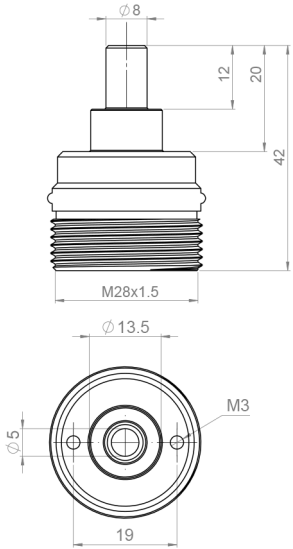

All dimensions in mm (1 mm = 0.03937 Inch)