

Ring Light

white light, 37 mm

LRLW100

Part Number



- Auto strobe (overdrive) light with robust housing & integrated current control
- Compact and powerful, designed for easy installation
- Flexibility: expand the beam angle with an Angle Changer
- IP67-certified LED ring light

wenglor LRLx100 ring lights are compact and bright ring lights with two operating modes: Continuous mode and strobe overdrive. The robust IP67 housing is equipped with magnets and fixing points for mounting angle changers, providing unparalleled flexibility in ring light illumination.

Technical Data

| Optical Data | |
|---|------------------------------|
| Light Source | White Light |
| Color temperature | 4500 K |
| Beam angle | ± 5 ° |
| White light output | 284400 Lux |
| Measuring point distance | 200 mm |
| Compatible with | Angle Changer |
| Environmental conditions | |
| Temperature Range | -10...40 °C |
| Storage temperature | -20...60 °C |
| Atmospheric humidity | < 80%, non-condensing |
| Electrical Data | |
| Supply Voltage | 21,6...26,4 V DC |
| Power | 15,4 W |
| Peak power | 63,36 W |
| Current Consumption Continuous Mode (Ub = 24 V) | 0,66 A |
| Current consumption flash mode overdrive (operating voltage = 24 V) | 2,64 A |
| Flash Duration (max.) | 10 ms |
| Duty Cycle (max.) | < 0,1 |
| Rise time | 15 µs |
| Fall time | 15 µs |
| Input signal | PNP/NPN |
| Short Circuit Protection | yes |
| Reverse Polarity Protection | yes |
| Overload Protection | yes |
| Protection Class | III |
| Dimming | 0...10 V ± 100...30% |
| Overdrive | yes |
| Mechanical Data | |
| Luminous Field | Ø 86 mm |
| Housing Material | Aluminum, anodised |
| Housing Material | Plastic, PMMA |
| Degree of Protection | IP67 |
| Connection | M12 × 1; 5-pin |
| Max. cable length | 10 m |
| Function | |
| Operating modes | Continuous, Strobe Overdrive |

Complementary Products

| |
|--------------------|
| Connection cables |
| Mounting adapter |
| ZRLG angle changer |

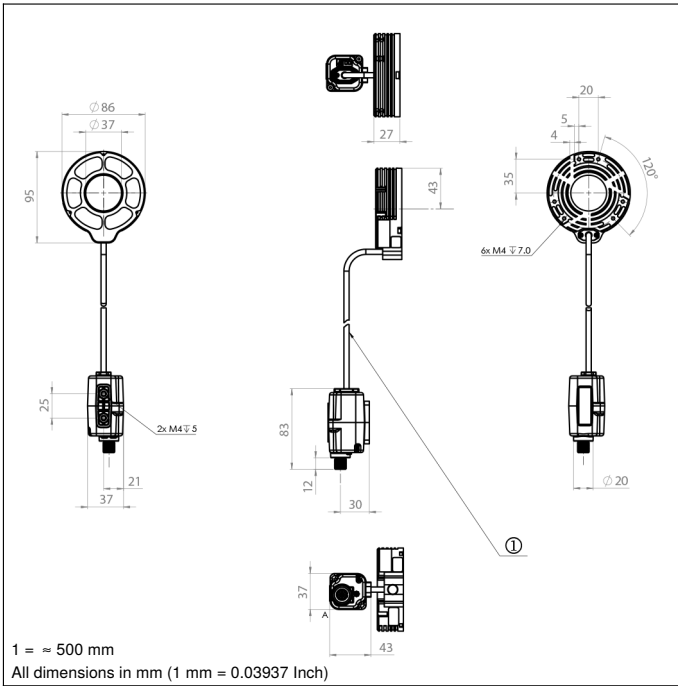
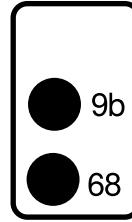
Ctrl. Panel
T21

68 = supply voltage indicator
 9b = Strobe Mode Indicator



| Legend | | | |
|-----------|--|----------|--|
| + | Supply Voltage + | nc | Not connected |
| - | Supply Voltage 0 V | U | Test Input |
| ~ | Supply Voltage (AC Voltage) | Ü | Test Input inverted |
| A | Switching Output (NO) | W | Trigger Input |
| Ā | Switching Output (NC) | W- | Ground for the Trigger Input |
| V | Contamination/Error Output (NO) | O | Analog Output |
| ȳ | Contamination/Error Output (NC) | O- | Ground for the Analog Output |
| E | Input (analog or digital) | BZ | Block Discharge |
| T | Teach Input | Amv | Valve Output |
| Z | Time Delay (activation) | a | Valve Control Output + |
| S | Shielding | b | Valve Control Output 0 V |
| RxD | Interface Receive Path | SY | Synchronization |
| TxD | Interface Send Path | SY- | Ground for the Synchronization |
| RDY | Ready | E+ | Receiver-Line |
| GND | Ground | S+ | Emitter-Line |
| CL | Clock | ± | Grounding |
| E/A | Output/Input programmable | SnR | Switching Distance Reduction |
| IO-Link | | Rx+/- | Ethernet Receive Path |
| PoE | Power over Ethernet | Tx+/- | Ethernet Send Path |
| IN | Safety Input | Bus | Interfaces-Bus A(+)/B(-) |
| OSSD | Safety Output | La | Emitted Light disengageable |
| Signal | Signal Output | Mag | Magnet activation |
| Bl_D+/- | Ethernet Gigabit bidirect. data line (A-D) | RES | Input confirmation |
| ENo RS422 | Encoder 0-pulse 0/0 (TTL) | EDM | Contactor Monitoring |
| PT | Platinum measuring resistor | ENARs422 | Encoder A/Ā (TTL) |
| | | | Encoder B/B̄ (TTL) |
| | | | Encoder A |
| | | | Encoder B |
| | | | Digital output MIN |
| | | | Digital output MAX |
| | | | Digital output OK |
| | | | Synchronization In |
| | | | Synchronization OUT |
| | | | Brightness output |
| | | | Maintenance |
| | | | Reserved |
| | | | Wire Colors according to DIN IEC 60757 |
| | | | BK Black |
| | | | BN Brown |
| | | | RD Red |
| | | | OG Orange |
| | | | YE Yellow |
| | | | GN Green |
| | | | BU Blue |
| | | | VT Violet |
| | | | GY Grey |
| | | | WH White |
| | | | PK Pink |
| | | | GNYE Green/Yellow |

