

# P1KHxxx

Reflex Sensors with Background Suppression



## Operating Instructions

# Table of Contents

- 1. General .....3**
  - 1.1 Information Concerning these Instructions .....3
  - 1.2 Explanations of Symbols .....3
  - 1.3 Limitation of Liability.....4
  - 1.4 Copyrights .....4
- 2. For Your Safety .....5**
  - 2.1 Use for Intended Purpose .....5
  - 2.2 Use for Other than the Intended Purpose.....5
  - 2.3 Personnel Qualifications .....6
  - 2.4 Modification of Products .....6
  - 2.5 General Safety Precautions .....6
  - 2.6 Laser/LED Warnings.....6
  - 2.7 Approvals and protection class .....7
- 3. Technical Data .....7**
  - 3.7.1 Spot Diameter.....9
  - 3.7.2 Switching Distance Deviation.....10
  - 3.1 Complementary Products .....11
  - 3.2 Layout.....11
  - 3.3 Control Panel.....14
  - 3.4 Scope of Delivery .....15
- 4. Transport and Storage .....15**
  - 4.1 Transport .....15
  - 4.2 Storage.....15
- 5. Installation and Electrical Connection .....16**
  - 5.1 Installation .....16
  - 5.2 Electrical Connection .....16
  - 5.3 Diagnostics.....17
- 6. Settings.....19**
  - 6.1 Object recognition on a background or underlying surface .....19
  - 6.2 Object recognition without disturbing background.....19
- 7. IO-Link .....19**
- 8. Maintenance Instructions .....20**
- 9. Proper Disposal .....20**
- 10. Appendix.....20**
  - 10.1 List of Abbreviations.....20
  - 10.2 Change Index, Operating Instructions.....20
  - 10.3 EU Declaration of Conformity .....20

# 1. General

## 1.1 Information Concerning these Instructions

- These instructions apply to the products with ID code P1KHxxx.
- They make it possible to use the product safely and efficiently.
- These instructions are an integral part of the product and must be kept on hand for the entire duration of its service life.
- Local accident prevention regulations and national work safety regulations must be complied with as well.
- The product is subject to further technical development, and thus the information contained in these operating instructions may also be subject to change. The current version can be found at [www.wenglor.com](http://www.wenglor.com) in the product's separate download area.



### NOTE!

The operating instructions must be read carefully before using the product and must be kept on hand for later reference.

## 1.2 Explanations of Symbols

- Safety precautions and warnings are emphasized by means of symbols and attention-getting words
- Safe use of the product is only possible if these safety precautions and warnings are adhered to

The safety precautions and warnings are laid out in accordance with the following principle:



### Attention-Getting Word! Type and Source of Danger!

Possible consequences in the event that the hazard is disregarded.

- Measures for averting the hazard.

The meanings of the attention-getting words, as well as the scope of the associated hazards, are listed below.



### DANGER!

This word indicates a hazard with a high degree of risk which, if not avoided, results in death or severe injury.



### WARNING!

This word indicates a hazard with a medium degree of risk which, if not avoided, may result in death or severe injury.



### CAUTION!

This word indicates a hazard with a low degree of risk which, if not avoided, may result in minor or moderate injury.



### ATTENTION!

This word draws attention to a potentially hazardous situation which, if not avoided, may result in property damage.



### NOTE!

A note draws attention to useful tips and suggestions, as well as information regarding efficient, error-free use.

### 1.3 Limitation of Liability

- The product has been developed in consideration of the current state-of-the-art and applicable standards and guidelines. Subject to change without notice.
- A valid declaration of conformity can be accessed at [www.wenglor.com](http://www.wenglor.com) in the product's separate download area.
- wenglor sensoric elektronische Geräte GmbH (hereinafter referred to as "wenglor") excludes all liability in the event of:
  - Non-compliance with the instructions
  - Use of the product for purposes other than those intended
  - Use by untrained personnel
  - Use of unapproved replacement parts
  - Unapproved modification of products
- These operating instructions do not include any guarantees from wenglor with regard to the described procedures or specific product characteristics.
- wenglor assumes no liability for printing errors or other inaccuracies contained in these operating instructions, unless wenglor was verifiably aware of such errors at the point in time at which the operating instructions were prepared.

### 1.4 Copyrights

- The contents of these instructions are protected by copyright law.
- All rights are reserved by wenglor.
- Commercial reproduction or any other commercial use of the provided content and information, in particular graphics and images, is not permitted without previous written consent from wenglor.

## 2. For Your Safety

### 2.1 Use for Intended Purpose

The product is based on the following functional principle:

#### Reflex Sensors with Background Suppression

Reflex sensors with background suppression analyze the light reflected from objects. As these sensors work according to the principle of angular measurement, the color, shape and surface characteristics of the object have almost no influence on the detection range. Even dark objects can be reliably detected against a bright background. The output is switched as soon as an object passes the selected range.

#### This product can be used in the following industry sectors:

- Special machinery manufacturing
- Heavy machinery manufacturing
- Logistics
- Automotive industry
- Food industry
- Packaging industry
- Pharmaceuticals industry
- Plastics industry
- Woodworking industry
- Consumer goods industry
- Paper industry
- Electronics industry
- Glass industry
- Steel industry
- Aviation industry
- Chemicals industry
- Alternative energy
- Raw materials extraction

### 2.2 Use for Other than the Intended Purpose

- Not a safety component in accordance with 2006/42/EC (Machinery Directive)
- The product is not suitable for use in potentially explosive atmospheres.
- The product may only be used with accessories supplied or approved by wenglor, or combined with approved products. A list of approved accessories and combination products can be accessed at [www.wenglor.com](http://www.wenglor.com) on the product detail page.

---

#### DANGER!



#### **Risk of personal injury or property damage in case of use for other than the intended purpose!**

Use for other than the intended purpose may lead to hazardous situations.

- Observe instructions regarding use for intended purpose.
-

## 2.3 Personnel Qualifications

- Suitable technical training is a prerequisite.
- In-house electronics training is required.
- Trained personnel must have uninterrupted access to the operating instructions.



**DANGER!**  
**Risk of personal injury or property damage in case of incorrect initial start-up and maintenance!**

Personal injury and damage to equipment may occur.

- Adequate training and qualification of personnel.

## 2.4 Modification of Products



**DANGER!**  
**Risk of personal injury or property damage if the product is modified!**

Personal injury and damage to equipment may occur. Non-observance may result in loss of the CE marking and the guarantee may be rendered null and void.

- Modification of the product is impermissible.

## 2.5 General Safety Precautions



- NOTE!**
- These instructions are an integral part of the product and must be kept on hand for the entire duration of its service life.
  - In the event of possible changes, the respectively current version of the operating instructions can be accessed at [www.wenglor.com](http://www.wenglor.com) in the product's download area.
  - Read the operating instructions carefully before using the product.
  - Protect the sensor against contamination and mechanical influences.

## 2.6 Laser/LED Warnings

The respective laser class or LED group is listed in the product's technical data.



**Laser Class 1 (EN 60825-1)**  
Applicable standards and safety regulations must be observed.  
 $P_p = 7 \text{ mW}$ ,  $t = 8 \text{ s}$ ,  $\lambda = 680 \text{ nm}$

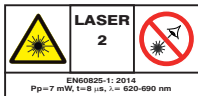

**Laser Class 2 (EN 60825-1)**  
Applicable standards and safety regulations must be observed. The enclosed laser warning labels must be attached and visible at all time. Do not stare into beam.

## 2.7 Approvals and protection class



## 3. Technical Data

Optical Data	
Service life (ambient temp. = +25 °C)	100000 h
Max. permissible ambient light	10000 Lux
Switching Hysteresis	< 10 %
Electrical Data	
Supply power	10...30 V DC
IO-Link supply voltage	18...30 V DC
Temperature range	−40...60 °C
Switching output voltage drop	< 2 V
Switching output switching current	100 mA
Switching output residual current	< 50 µA
Short-circuit protection	Yes
Reverse polarity protected	Yes
Overload-proof	Yes
Lockable	Yes
Interface	IO-Link
IO-Link version	1.1
Protection class	III
Mechanical Data	
Setting method	Potentiometer
Housing material	Plastic
Degree of protection	IP67 / IP68
Lens cover	PMMA

Order Number		P1KH															
		001	002	003	004	005	013	014	010	011	012	019	006	007	008	015	009
Range				150 mm					300 mm			150 mm		120 mm			
Adjustable Range				30...150 mm					30...300 mm			30...150 mm		30...120 mm			
Light Source					Red Light							Blue Light		Laser (red)			
Laser Class (EN 60825-1)						—								1			2
Spot Diameter				see Table 1					see Table 2			see Table 3		see Table 4			
Current consumption									< 20 mA				< 15 mA				
Switching frequency									1000 Hz								
Response time									0,5 ms								
Switching frequency (Interference-free-Mode)									500 Hz								
Response time (Interference-free-Mode)									1 ms								
Temperature drift		< 5 %							< 5 %*			< 5 %					
Setting method				Potentiometer					Potentiometer (Multi-turn)				Potentiometer				
Output function	PNP	x	x	x	x	x			x	x	x	x	x	x	x		x
	NPN						x	x								x	
	NC, NO antivalent	x	x	x			x	x	x	x		x	x	x		x	x
	NO				x						x				x		
	NC					x											
Connection		Cable, 2 m	M8×1	M12×1	M8×1			Cable, 2 m	M8×1	M12×1		M8×1		M12×1	M8×1		
Connection diagram No.		214	215	216	217	213	212	215	216	215		216	213	215			
Suitable mounting technology No.		—	7	2	8	7	—	7	2	8	7		2	8	7		

\* For the sensors P1KH010-P1KH012 the Temperature drift is depending on the ambient temperature:  
 Temperature drift (0 °C < Tu < 40 °C): < 5 %  
 Temperature drift (-20 °C < Tu < 0 °C, 40 °C < Tu < 50 °C): < 10 %  
 Temperature drift (Tu < -20 °C, Tu > 50 °C): < 13 %



### 3.7.1 Spot Diameter

Range	50 mm	100 mm	150 mm
Spot diameter	5 mm	7 mm	10 mm

Table 1

Range	30 mm	130 mm	300 mm
Spot diameter	8 mm	7 mm	18 mm

Table 2

Range	50 mm	100 mm	150 mm
Spot diameter	5 mm	7 mm	10 mm

Table 3

Range	40 mm	80 mm	120 mm
Spot diameter	2,5 mm	1,5 mm	1 mm

Table 4

3.7.2 Switching Distance Deviation

Typical characteristic curve based on Kodak white (90 % remission).

P1KH001-P1KH005, P1KH013, P1KH014:

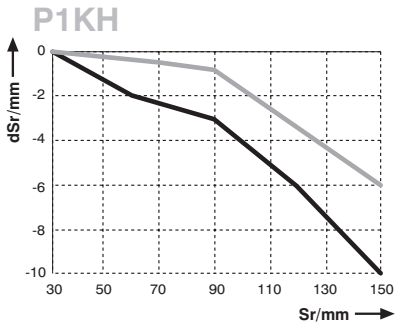

P1KH006-P1KH009, P1KH015:

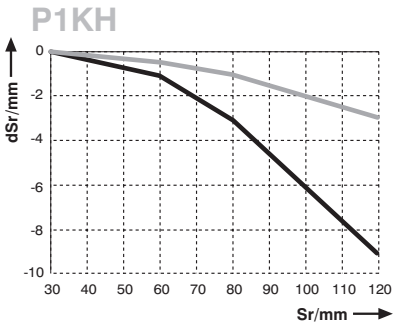

P1KH019

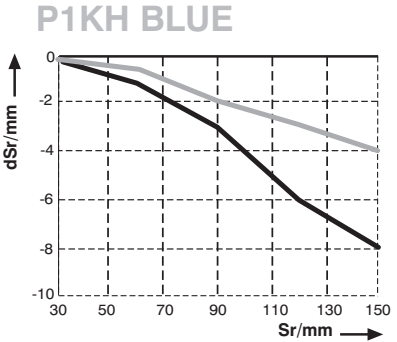

P1KH010-P1KH012

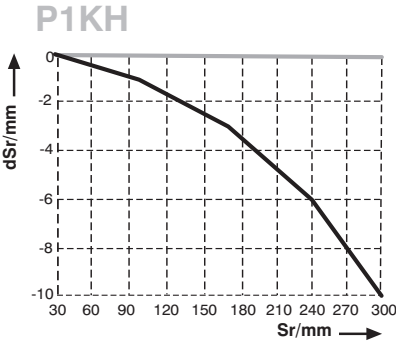

Sr = Switching Distance  
dSr = Switching Distance Change  
Black 6 % remission  
Grey 18 % remission

3.1 Complementary Products

wenglor can provide you with suitable connection technology for your product.

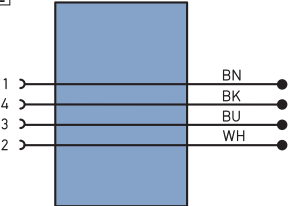
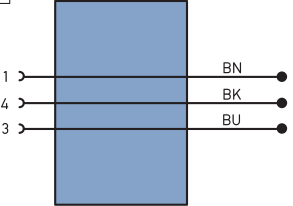
Suitable mounting technology no.	400		
Suitable connection technology no.	7	2	8
	<div>S02</div> 		<div>S04</div> 
PNP-NPN converter BG7V1P-N-2M			
IO-Link master			
wTeach2 software DNNF005			

3.2 Layout

P1KH002, P1KH004, P1KH005, P1KH013, P1KH019

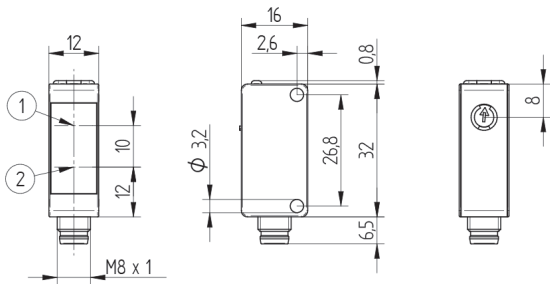

P1KH001, P1KH014

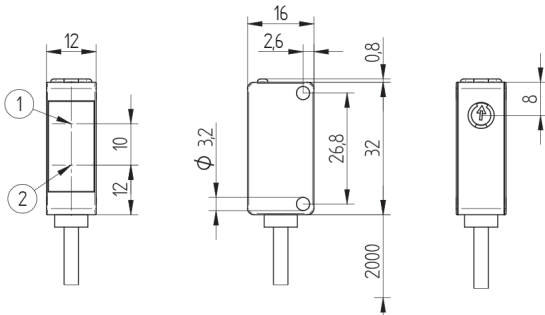

P1KH003

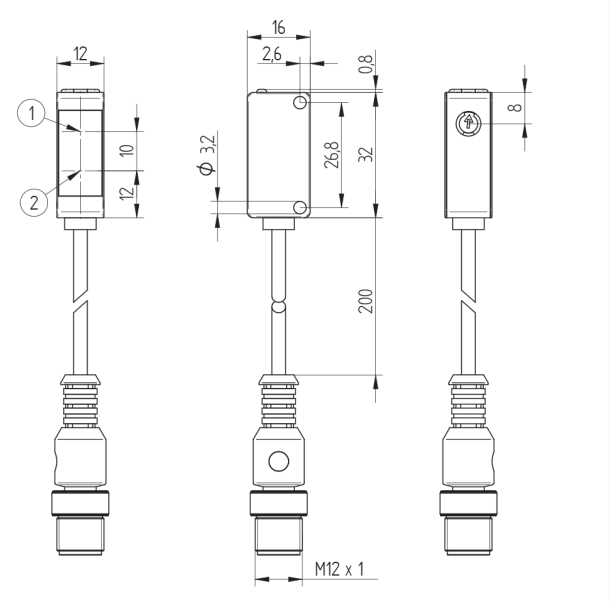

P1KH010, P1KH012

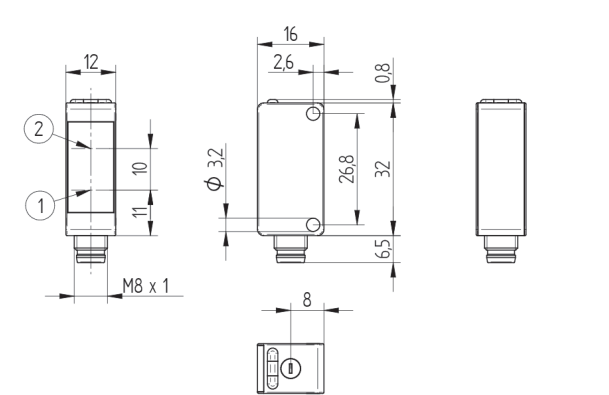

# P1KH011

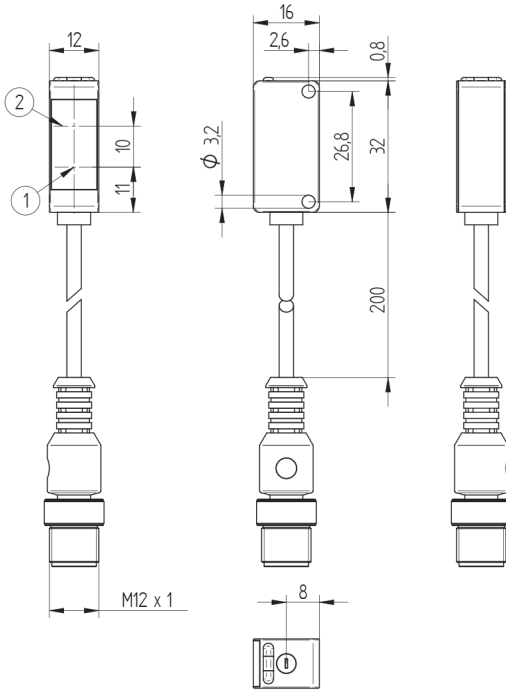

# P1KH006, P1KH008, P1KH009, P1KH015

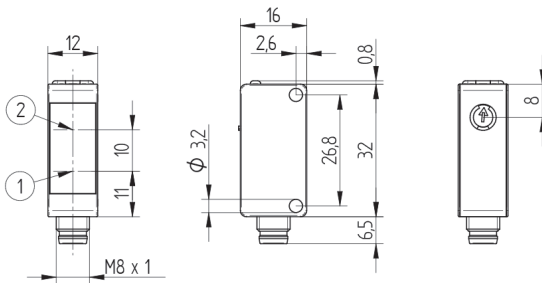

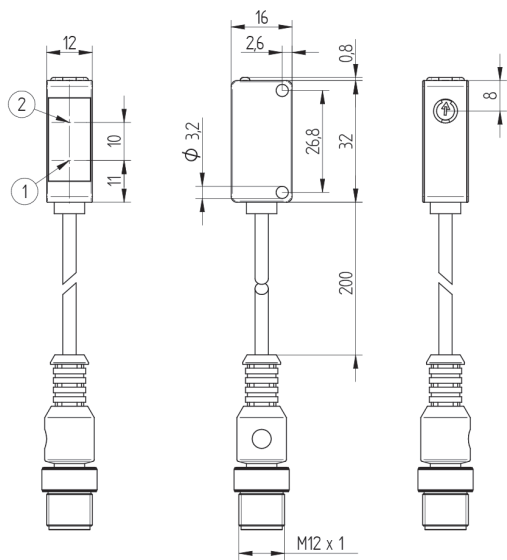

- ① = Emitter diode  
② = Receiving diode  
Screw M3 = 0,5 Nm  
Potentiometer = 40 Nmm  
Dimensions specified in mm (1 mm = 0,03937 Inch)

3.3 Control Panel

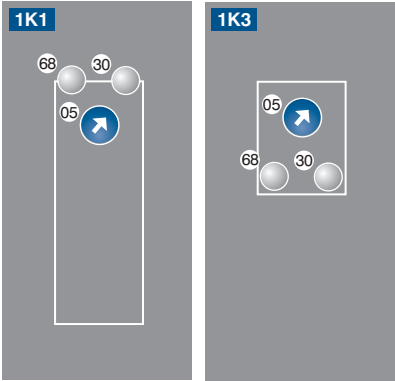

- 05 = switching distance adjuster  
30 = switching status indicator / contamination warning  
68 = supply power indicator

### 3.4 Scope of Delivery

- Sensor
- Safety precautions
- Laser warning label (for Class 2)
- Mounting-Set 01

## 4. Transport and Storage

### 4.1 Transport

Upon receipt of shipment, the goods must be inspected for damage in transit. In the case of damage, conditionally accept the package and notify the manufacturer of the damage. Then return the device, making reference to damage in transit.

### 4.2 Storage

**The following points must be taken into condition with regard to storage:**

- Do not store the product outdoors.
- Store the product in a dry, dust-free place.
- Protect the product against mechanical impacts.
- Protect the product against exposure to direct sunlight.



#### **ATTENTION!**

#### **Risk of property damage in case of improper storage!**

The product may be damaged.

- Storage instructions must be complied with.
-

# 5. Installation and Electrical Connection

## 5.1 Installation

- Protect the product from contamination during installation.
- Observe all applicable electrical and mechanical regulations, standards, and safety rules.
- Protect the product against mechanical influences.
- Make sure that the sensor is mounted in a mechanically secure fashion.
- Specified torque values must be complied with (see section “3. Technical Data”, page 7).

### ATTENTION!



#### Risk of property damage in case of improper installation!

The product may be damaged.

- Installation instructions must be complied with.

### CAUTION!



#### Risk of personal injury or property damage during installation!

Personal injury and damage to the product may occur.

- A safe installation environment must be assured.

## 5.2 Electrical Connection

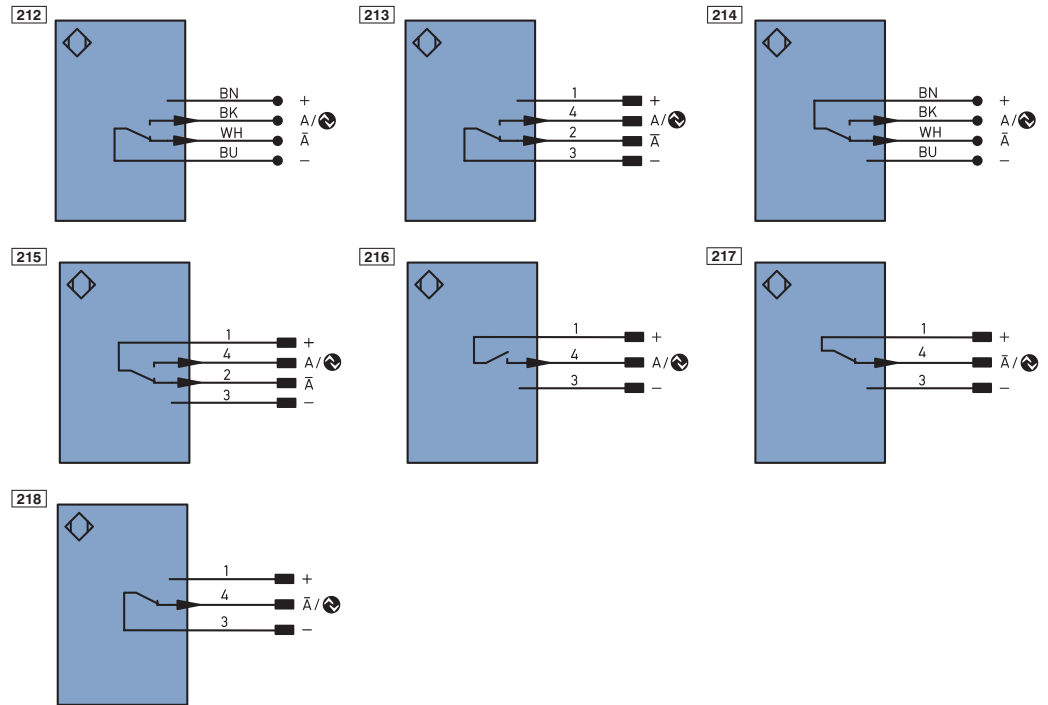



## Legend

+	Supply Voltage +
–	Supply Voltage 0 V
~	Supply Voltage (AC Voltage)
A	Switching Output (NO)
Ā	Switching Output (NC)
V	Contamination/Error Output (NO)
Ī	Contamination/Error Output (NC)
E	Input (analog or digital)
T	Teach Input
Z	Time Delay (activation)
S	Shielding
RxD	Interface Receive Path
TxD	Interface Send Path
RDY	Ready
GND	Ground
CL	Clock
E/A	Output/Input programmable
	IO-Link
PoE	Power over Ethernet
IN	Safety Input
OSSD	Safety Output
Signal	Signal Output
BI_D +/-	Ethernet Gigabit bidirect. data line (A-D)
EN <sub>RS422</sub>	Encoder 0-pulse 0-0̄ (TTL)

PT	Platinum measuring resistor
nc	not connected
U	Test Input
Ū	Test Input inverted
W	Trigger Input
O	Analog Output
O–	Ground for the Analog Output
BZ	Block Discharge
AMV	Valve Output
a	Valve Control Output +
b	Valve Control Output 0 V
SY	Synchronization
E+	Receiver-Line
S+	Emitter-Line
⊕	Grounding
SnR	Switching Distance Reduction
Rx+/-	Ethernet Receive Path
Tx+/-	Ethernet Send Path
Bus	Interfaces-Bus A(+)/B(-)
La	Emitted Light disengageable
Mag	Magnet activation
RES	Input confirmation
EDM	Contactor Monitoring
EN <sub>AR542</sub>	Encoder A/Ā (TTL)
EN <sub>BR542</sub>	Encoder B/B̄ (TTL)

ENa	Encoder A
ENb	Encoder B
AMIN	Digital output MIN
AMAX	Digital output MAX
AOK	Digital output OK
SY In	Synchronization In
SY OUT	Synchronization OUT
OLt	Brightness output
M	Maintenance

## Wire Colors according to DIN IEC 757

BK	Black
BN	Brown
RD	Red
OG	Orange
YE	Yellow
GN	Green
BU	Blue
VT	Violet
GY	Grey
WH	White
PK	Pink
GYNE	Green/Yellow

## DANGER!



### Risk of personal injury or property damage due to electric current!

Voltage conducting parts may cause personal injury or damage to equipment.



- The electric device may only be connected by appropriately qualified personnel.



## 5.3 Diagnostics



Causes for Triggering the Contamination Warning (blinking LED):

Display LED	Diagnosis/Cause	Elimination
Continuous blinking at approx. 2.5 Hz	Contamination	Carefully clean the optic cover with a cloth.
	Aged emitter diode	Replace the sensor.
	Unreliable working range	<ul style="list-style-type: none"> <li>• Increase the sensor's switching distance.</li> <li>• Reduce distance between sensor and object.</li> </ul>
Continuous blinking at approx. 5 Hz	Short-circuit	Check electrical wiring and eliminate the short-circuit.
	Over-temperature	Disconnect the sensor from supply power and allow it to cool down.
	Hardware error	Replace the sensor.

Contamination Warning Flowcharts

Reflex Mode		no contamination		
				
Object		not detected	detected	not detected
Switching Status Indicator		off ○	on ●	off ○

		beginning contamination		
				
Object		not detected	detected	not detected
Switching Status Indicator		off ○	blinking ●	off ○

		advanced contamination		
				
Object		not detected	not detected	not detected
Switching Status Indicator		off ○	off ○	off ○

## Required action in case of fault:



### NOTE!

- Shut down the machine.
- Analyze and eliminate the cause of error with the help of the diagnostics information.
- If the error cannot be eliminated, please contact wenglor's support department.
- Do not operate in case of indeterminate malfunctioning.
- The machine must be shut down if the error cannot be unequivocally clarified or reliably eliminated.



---

### DANGER!

#### **Risk of personal injury or property damage in case of non-compliance!**

The system's safety function is disabled. Personal injury and damage to equipment.

- Required action as specified in case of fault.
- 

## 6. Settings

### 6.1 Object recognition on a background or underlying surface

- Adjust the instrument and securely fix it, so that the beam spot falls on the object to be detected.
- Remove the object and turn back the adjustment screw until the apparatus switches off. The background and underlying surface are now suppressed.
- Replace the object under the illuminated spot and check that the Sensor switches on again.

### 6.2 Object recognition without disturbing background

- Adjust the instrument and securely fix it, so that the beam spot falls on the object to be detected.
- Turn back the adjustment screw until the apparatus switches off and then turn it forward to until it switches on. If necessary turn it forward a bit further to increase the reliability of the switching.

## 7. IO-Link

Further settings are possible via the IO-Link interface. The IODD can be found at [www.wenglor.com](http://www.wenglor.com) in the product's download area.

## 8. Maintenance Instructions



**NOTE!**

- This wenglor sensor is maintenance-free.
- Cleaning and inspection of the plug connections at regular intervals are advisable.
- Do not clean the sensor with solvents or cleansers which could damage the product.
- The product must be protected against contamination during initial start-up.

## 9. Proper Disposal

wenglor sensoric GmbH does not accept the return of unusable or irreparable products. Respectively valid national waste disposal regulations apply to product disposal.

## 10. Appendix

### 10.1 List of Abbreviations

Abbreviation	Meaning
Tu	Ambient temperature
Ub	Supply voltage
IODD	IO Device Description
MTTFd	Mean Time to Dangerous Failure

### 10.2 Change Index, Operating Instructions

Version	Date	Description/Change
1.0.0	28.06.17	Initial version of the operating instructions

### 10.3 EU Declaration of Conformity

The EU declaration of conformity can be found on our website at [www.wenglor.com](http://www.wenglor.com) in the product's download area.