

Temperature Sensor with IO-Link

FXTT015

Part Number

weFlux² InoxSens



- FDA compliant
- Ready for Industry 4.0 with IO-Link 1.1
- Response time T90: < 2 seconds
- Temperature measuring range: -50 ... +150° C

weFlux² Temperature Sensors ensure precise temperature measurement of liquids and gases in closed piping systems. Either 2 switching outputs, 1 switching output and 1 analog output or one 2-wire analog output is available depending on settings and connection configuration. The outputs can be configured as desired via IO-Link in order to flexibly adapt the sensors to the respective application.

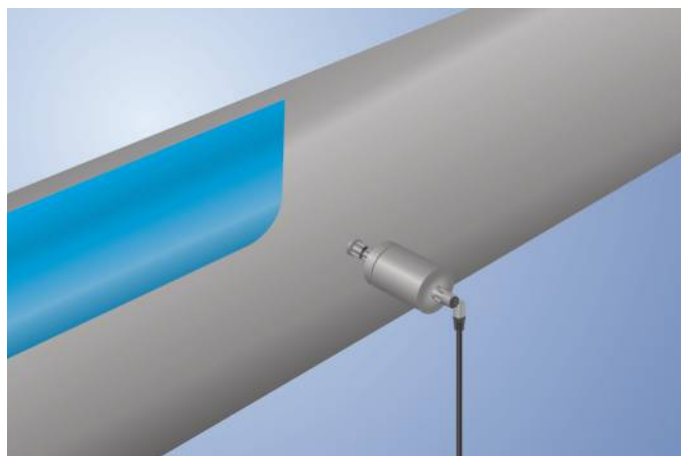

Technical Data

Sensor-specific data

Temperature Measurement Range	-50...150 °C
Setting Range	-50...150 °C
Medium	Liquids, gases
Measuring error	± 0,5 °C
Resolution	> 11 bit
Response Time	< 2 s

Environmental conditions

Temperature of medium	-50...150 °C
Ambient temperature	-25...80 °C
Storage temperature	-25...80 °C
Pressure Resistance	40 bar
EMC	DIN EN 61326-1
Shock Resistance	IEC 60751
Vibration resistance	IEC 60751

Electrical Data

2-wire supply power	12...32 V DC
3-wire supply power	12...32 V DC
Current Consumption (U _b = 24 V)	< 15 mA
Number of Switching Outputs	2
Switching Output/Switching Current	± 100 mA
Switching Output Voltage Drop	< 1,5 V DC
Analog Output	4...20 mA
Signal source	Temperature
Short Circuit Protection	yes
Reverse Polarity Protection	yes
Protection Class	III
Interface	IO-Link V1.1

Mechanical Data

Setting Method	IO-Link
Housing Material	1.4404
Material in contact with media	1.4404
Degree of Protection	IP68/IP69K *
Connection	M12 × 1; 4-pin
Process Connection	Dairy pipe DN25
Process Connection Length (PCL)	54 mm
Probe Length (PL)	36 mm

Safety-relevant Data

MTTFd (EN ISO 13849-1)	1198,4 a
Analog Output	●
IO-Link	●
PNP NO	●
Connection Diagram No.	139
Suitable Connection Equipment No.	2

* Certified by wenglor

Complementary Products

IO-Link Master Software	
-------------------------	--

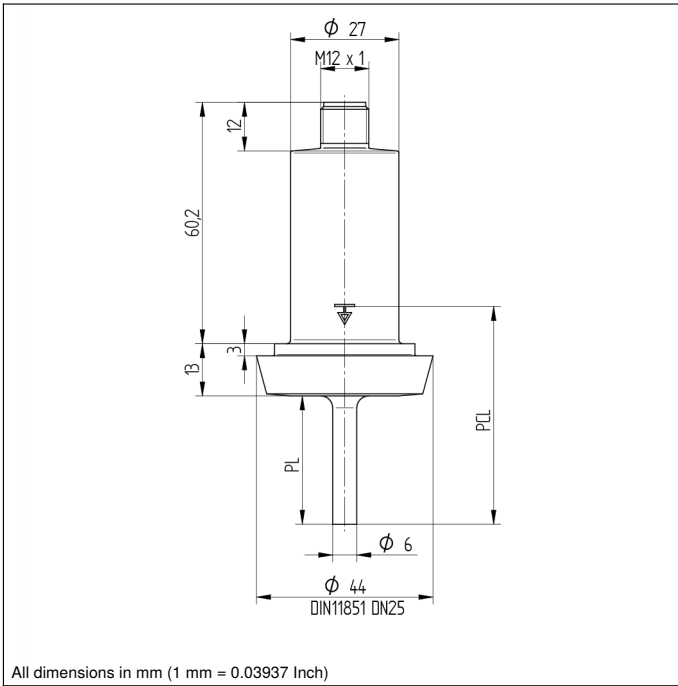

All dimensions in mm (1 mm = 0.03937 Inch)

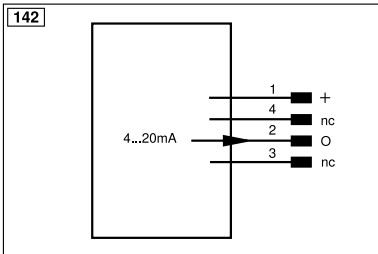
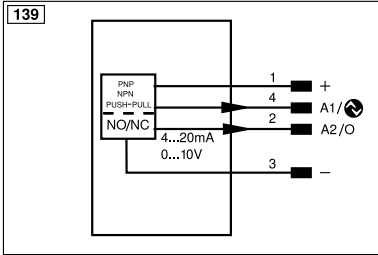

Legend			
+	Supply Voltage +	nc	Not connected
-	Supply Voltage 0 V	U	Test Input
~	Supply Voltage (AC Voltage)	Ü	Test Input inverted
A	Switching Output (NO)	W	Trigger Input
Ā	Switching Output (NC)	W-	Ground for the Trigger Input
V	Contamination/Error Output (NO)	O	Analog Output
ȳ	Contamination/Error Output (NC)	O-	Ground for the Analog Output
E	Input (analog or digital)	BZ	Block Discharge
T	Teach Input	Amv	Valve Output
Z	Time Delay (activation)	a	Valve Control Output +
S	Shielding	b	Valve Control Output 0 V
RxD	Interface Receive Path	SY	Synchronization
TxD	Interface Send Path	SY-	Ground for the Synchronization
RDY	Ready	E+	Receiver-Line
GND	Ground	S+	Emitter-Line
CL	Clock	±	Grounding
E/A	Output/Input programmable	SnR	Switching Distance Reduction
IO-Link		Rx+/-	Ethernet Receive Path
PoE	Power over Ethernet	Tx+/-	Ethernet Send Path
IN	Safety Input	Bus	Interfaces-Bus A(+)/B(-)
OSSD	Safety Output	La	Emitted Light disengageable
Signal	Signal Output	Mag	Magnet activation
BI_D+/-	Ethernet Gigabit bidirect. data line (A-D)	RES	Input confirmation
ENo RS422	Encoder 0-pulse 0/0 (TTL)	EDM	Contact Monitoring
PT	Platinum measuring resistor	ENARs422	Encoder A/Ā (TTL)
			Encoder B/B̄ (TTL)
			Encoder A
			Encoder B
			Digital output MIN
			Digital output MAX
			Digital output OK
			Synchronization In
			Synchronization OUT
			Brightness output
			Maintenance
			Reserved
			Wire Colors according to DIN IEC 60757
			BK Black
			BN Brown
			RD Red
			OG Orange
			YE Yellow
			GN Green
			BU Blue
			VT Violet
			GY Grey
			WH White
			PK Pink
			GNYE Green/Yellow

