

FXFF1xx

Flow Sensor with 2 Analog Outputs



Operating Instructions

Translation of the Original Operating Instruction
Subject to change without notice
Available as PDF version only
Version: 1.7.0
Status: 30.06.2022
www.wenglor.com

Table of Contents

- 1. General 4**
 - 1.1 Information Concerning these Instructions 4
 - 1.2 Explanations of Symbols..... 4
 - 1.3 Limitation of Liability..... 5
 - 1.4 Copyrights..... 5
- 2. For Your Safety 6**
 - 2.1 Use for Intended Purpose 6
 - 2.2 Use for Other than the Intended Purpose..... 7
 - 2.3 Personnel Qualifications 7
 - 2.4 Modification of Products..... 7
 - 2.5 General Safety Precautions 7
 - 2.6 Approvals and IP Protection 8
- 3. Technical Data 8**
 - 3.1 Default Settings..... 9
 - 3.2 Permissible Flow Rate 10
 - 3.3 Volumetric Flow 10
 - 3.4 Housing Dimensions 11
 - 3.5 Wiring Diagram 12
 - 3.6 Accessory Products 12
 - 3.7 Layout..... 13
 - 3.8 Scope of Delivery..... 13
- 4. Transport and Storage 14**
 - 4.1 Transport..... 14
 - 4.2 Storage 14
- 5. Installation and Electrical Connection..... 15**
 - 5.1 System Overview 15
 - 5.2 Installation..... 16
 - 5.4 Electrical Connection 18
 - 5.5 Diagnostics 18
- 6. Cleaning..... 18**

7. Maintenance Instructions	18
8. Returns	19
9. Proper Disposal	19
10. Appendix	19
10.1 Change Index, Operating Instructions	19
10.2 EU Declaration of Conformity	19

1. General

1.1 Information Concerning these Instructions

- These instructions apply to the product with ID code FXFF1xx.
- They make it possible to use the product safely and efficiently.
- These instructions are an integral part of the product and must be kept on hand for the entire duration of its service life.
- Local accident prevention regulations and national work safety regulations must be complied with as well.
- The product is subject to further technical development, and thus the information contained in these operating instructions may also be subject to change. The current version can be found at www.wenglor.com in the product's separate download area.



NOTE!

The operating instructions must be read carefully before using the product and must be kept on hand for later reference!

1.2 Explanations of Symbols

- Safety precautions and warnings are emphasized by means of symbols and attention-getting words.
- Safe use of the product is only possible if these safety precautions and warnings are adhered to.
- The safety precautions and warnings are laid out in accordance with the following principle:



**Attention-Getting Word
Type and Source of Danger!**

Possible consequences in the event that the hazard is disregarded.

- Measures for averting the hazard.

The meanings of the attention-getting words, as well as the scope of the associated hazards, are listed below.



DANGER!

This word indicates a hazard with a high degree of risk which, if not avoided, results in death or severe injury.



WARNING!

This word indicates a hazard with a medium degree of risk which, if not avoided, may result in death or severe injury.



CAUTION!

This word indicates a hazard with a low degree of risk which, if not avoided, may result in minor or moderate injury.



ATTENTION!

This word draws attention to a potentially hazardous situation which, if not avoided, may result in property damage.

**NOTE!**

A note draws attention to useful tips and suggestions, as well as information regarding efficient, error-free use.

1.3 Limitation of Liability

- The product has been developed in consideration of the current state-of-the-art and applicable standards and guidelines. Subject to change without notice. A valid declaration of conformity can be accessed at www.wenglor.com in the product's separate download area.
- wenglor sensoric elektronische Geräte GmbH (hereinafter referred to as "wenglor") excludes all liability in the event of:
 - Non-compliance with the instructions
 - Use of the product for purposes other than those intended
 - Use by untrained personnel
 - Use of unapproved replacement parts
 - Unapproved modification of products
- These operating instructions do not include any guarantees from wenglor with regard to the described procedures or specific product characteristics.
- wenglor assumes no liability for printing errors or other inaccuracies contained in these operating instructions, unless wenglor was verifiably aware of such errors at the point in time at which the operating instructions were prepared.

1.4 Copyrights

- The contents of these instructions are protected by copyright law.
- All rights are reserved by wenglor.
- Commercial reproduction or any other commercial use of the provided content and information, in particular graphics and images, is not permitted without previous written consent from wenglor.

2. For Your Safety

2.1 Use for Intended Purpose

The product is based on the following functional principle:

Flow Sensor

The Flow Sensor measures the flow rates of aqueous media in closed piping systems.

The wenglor Flow Sensor functions in accordance with the calorimetric measuring principle. This makes it possible to monitor the temperature of the medium in addition to the flow rate. The sensor detects changes to both characteristic process values and converts them into an electrical signal.

The sensor is equipped with 2 analog outputs (4 ... 20 mA).

This product can be used in the following industry sectors:

- Special machinery manufacturing
- Heavy machinery manufacturing
- Logistics
- Automotive industry
- Food industry
- Packaging industry
- Pharmaceuticals industry
- Clothing industry
- Plastics industry
- Woodworking industry
- Consumer goods industry
- Paper industry
- Electronics industry
- Glass industry
- Steel industry
- Printing industry
- Construction industry
- Chemicals industry
- Agriculture industry
- Alternative energy
- Raw materials extraction

2.2 Use for Other than the Intended Purpose

- Not a safety component in accordance with 2006/42/EC (Machinery Directive)
- The product is not suitable for use in potentially explosive atmospheres.
- The product may only be used with accessories supplied or approved by wenglor, or in combination with approved products. A list of approved accessories and combination products can be accessed at www.wenglor.com on the product detail page.



DANGER!

Risk of personal injury or property damage in case of use for other than the intended purpose!

Use for other than the intended purpose may lead to hazardous situations.

- Instructions regarding use for intended purpose must be observed.

2.3 Personnel Qualifications

- Suitable technical training is a prerequisite.
- In-house electronics training is required.
- Trained personnel must have uninterrupted access to the operating instructions.



DANGER!

Risk of personal injury or property damage in case of incorrect initial start-up and maintenance!

Personal injury and damage to equipment may occur.

- Adequate training and qualification of personnel.

2.4 Modification of Products



DANGER!

Risk of personal injury or property damage if the product is modified!

Personal injury and damage to equipment may occur. Non-observance may result in loss of the CE marking and the guarantee may be rendered null and void.

- Modification of the product is impermissible.

2.5 General Safety Precautions



NOTE!

- These instructions are an integral part of the product and must be kept on hand for the entire duration of its service life.
- In the event of possible changes, the respectively current version of the operating instructions can be accessed at www.wenglor.com in the product's separate download area.
- Read the operating instructions carefully before using the product.
- Protect the sensor against contamination and mechanical influences.
- Installation and removal of the product are only permissible in pressure-free piping systems which have been allowed to cool down.

2.6 Approvals and IP Protection



3. Technical Data

Order Number		FXFF1xx
Technical Data		
Sensor-Specific Data		
Flow		
Flow measuring range within a medium temperature range of 0*...125° C		10...400 cm/s
Medium		Water**
Flow measurement error		up to 2 %
Response Time		1...5 s
Reaction time in case of abrupt temperature change		< 10 s
Sensor-Specific Data		
Temperature		
Temperature measuring range		-25...150° C
Medium		Water
Temperature measurement error		± 1° C (water; flow velocities 10...400 cm/s)
Step response time T90		< 5 s
Ambient Conditions		
Ambient temperature		-25...80° C
Media temperature		-25...125° C
Storage and transport temperature		-25...80° C
Relative humidity		100 %
EMC		EN 61326-1
Shock resistance per DIN EN 60068-2-27		30 g / 11 ms
Vibration resistance per DIN EN 60068-2-6		5 g (10...2000 Hz)
Electrical Data		
Supply power		12...32 V DC
Current consumption (Uo = 24 V)		≤ 45 mA
Short-circuit proof		Yes
Reverse polarity and overload-proof		Yes
Analog output		4...20 mA
Output load resistance		< $\frac{(U_b - U_{min})}{20 \text{ mA}}$
Protection class		III
Operating delay time		< 10 s

Mechanical Data	
Housing material	Stainless steel 1.4404
Media contacting materials	Stainless steel 1.4404
Protection	IP68, IP69K
Connector Type	M12×1, 4-pin
Process connection	See data sheet
Process connection length PCL	See data sheet
Probe length PL	See data sheet
Rod diameter	6 mm
Connection cable length	up to 30 m
Output Function	
Analog flow rate output	Pin 2
Analog temperature output	Pin 4

- * **Note:** The sensors were calibrated and specified for the medium water. Technically, the sensors are suitable for a medium temperature of up to -25°C . To achieve a temperature below 0°C , a different medium must be added to the water. This leads to a different measurement result, which is why a use under 0°C must be tested individually for the mixture used.
- ** Reference conditions: Medium water at $26^{\circ}\text{C} \pm 1^{\circ}\text{C}$, $1\text{ bar} \pm 0.2\text{ bar}$, vertical installation in the tube, sensor tip in the middle of the tube, tube inner diameter (d) 25 mm, inlet section $> 12 \times d$, outlet section $> 12 \times d$

The following table specifies the tightening torques of the plugs and mounting options in order to assure compliant, error-free operation:

Connector Type	Tightening Torque (Nm)
M12	0,4

CAUTION!



- Pressure resistance specified in the data sheet always makes reference to the sensor rod.
- Amongst other factors, the system's pressure resistance is also dependent on the utilized mounting components (adapters), and is only as high as the pressure resistance of the weakest component.

3.1 Default Settings

		FXXF1xx
Function A1	Output	Analog Output
	Measurement, physical quantity	Temperature
	Output function	4...20 mA
	Initial value, analog output	-25°C
	Final value, analog output	150°C
Function A2	Output	Analog Output
	Measurement, physical quantity	Flow
	Output function	Current 4...20 mA
	Initial value, analog output	0 m/s
	Final value, analog output	4 m/s

3.2 Permissible Flow Rate

Maximum permissible flow rate depending on the temperature of the medium, pressure and probe length:

Pressure	Probe Length					Medium Temperature
	10 mm	50 mm	100 mm	150 mm	200 mm	
PN25 (25 bar)	400 cm/s	400 cm/s	400 cm/s	400 cm/s	400 cm/s	20° C
						60° C
						100° C
						150° C
PN40 (40 bar)	400 cm/s	400 cm/s	400 cm/s	400 cm/s	400 cm/s	20° C
						60° C
					350 cm/s	100° C
						150° C
PN64 (64 bar)	400 cm/s	400 cm/s	400 cm/s	400 cm/s	200 cm/s	20° C
					150 cm/s	60° C
						100° C
						150° C
PN100 (100 bar)	400 cm/s	400 cm/s	400 cm/s	400 cm/s	Not permissible	20° C
				350 cm/s		60° C
				300 cm/s		100° C
						150° C

3.3 Volumetric Flow

The Flow Sensor measures the flow rate at the tip of the sensor.
The pipe's inside diameter and the flow rate must be known in order to determine volumetric flow within a piping system.
The volumetric flow rate can be easily ascertained with the help of wenglor's flow calculator, which is available from our website at www.wenglor.com on the product detail page under software.

Flow Rate \ Nominal Size Inside dia.	DN25	DN40	DN65	DN100
	28.5 mm	43.1 mm	70.3 mm	107.1 mm
100 cm/s	33 l/min	80 l/min	220 l/min	521 l/min
150 cm/s	50 l/min	120 l/min	330 l/min	782 l/min
200 cm/s	66 l/min	160 l/min	441 l/min	1043 l/min
250 cm/s	83 l/min	200 l/min	551 l/min	1303 l/min
300 cm/s	100 l/min	239 l/min	661 l/min	1564 l/min
350 cm/s	116 l/min	279 l/min	771 l/min	1824 l/min
400 cm/s	133 l/min	319 l/min	881 l/min	2085 l/min

3.4 Housing Dimensions

See the product selector for other process connections (<https://www.wenglor.com/index.php?id=965&L=1>). Overall housing dimensions are included in the respective data sheet.

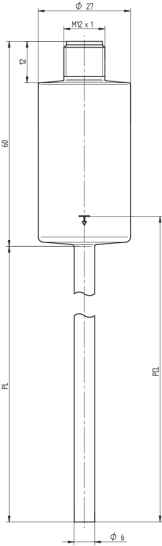
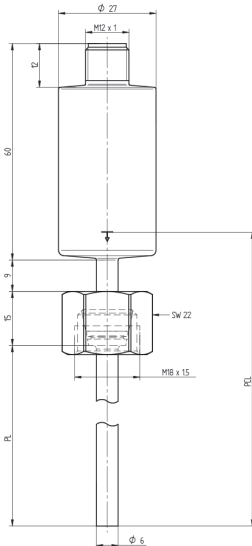
Cutting/Locking Ring	M18×1 Sealing Cone
	

Process connection length PCL in the case of a cutting/locking ring = probe length PL + 9 mm

Process connection length PCL in the case of an M18×1 sealing cone = probe length PL + 32 mm

NOTE!

- There's a marking on the sensor's sleeve (see figure).
- This is a reference point (starting point) relative to the length of the process connection (see data sheet or instructions), and provides assistance in correctly positioning the sensor within the piping system.



3.5 Wiring Diagram

141

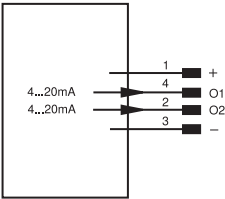

Legend

+	Supply Voltage +	PT	Platinum measuring resistor	EN ^A EN ^B EN ^C	Encoder A/Ä (TTL)
-	Supply Voltage 0 V	nc	not connected	EN ^B EN ^C	Encoder B/B (TTL)
~	Supply Voltage (AC Voltage)	U	Test Input	EN ^A	Encoder A
A	Switching Output (NO)	Ū	Test Input inverted	EN ^B	Encoder B
Ä	Switching Output (NC)	W	Trigger Input	AMIN	Digital output MIN
V	Contamination/Error Output (NO)	W-	Ground for the Trigger Input	AMAX	Digital output MAX
Ų	Contamination/Error Output (NC)	O	Analog Output	ADK	Digital output OK
E	Input (analog or digital)	O-	Ground for the Analog Output	SY In	Synchronization In
T	Teach Input	BZ	Block Discharge	SY OUT	Synchronization OUT
Z	Time Delay (activation)	AWV	Valve Output	OLY	Brightness output
S	Shielding	a	Valve Control Output +	M	Maintenance
RxD	Interface Receive Path	b	Valve Control Output 0 V	rSV	reserved
TxD	Interface Send Path	SY	Synchronization	Wire Colors according to IEC 60757	
RDY	Ready	SY-	Ground for the Synchronization	BK	Black
GND	Ground	E+	Receiver-Line	BN	Brown
CL	Clock	S+	Emitter-Line	RD	Red
E/A	Output/Input programmable	±	Grounding	OG	Orange
IO-Link		SrR	Switching Distance Reduction	YE	Yellow
PoE	Power over Ethernet	Rx+/-	Ethernet Receive Path	GN	Green
IN	Safety Input	Tx+/-	Ethernet Send Path	BU	Blue
OSD	Safety Output	BuA	Interfaces-Bus A(+)/B(-)	VT	Violet
Signal	Signal Output	La	Emitted Light disengageable	GY	Grey
BL_D+/-	Ethernet Gigabit bidirect. data line (A-D)	Mag	Magnet activation	WH	White
EN ⁰ EN ^{MAX}	Encoder 0-pulse 0-0 (TTL)	RES	Input confirmation	PK	Pink
		EDM	Contactur Monitoring	GNYE	Green/Yellow

3.6 Accessory Products

wenglor can provide you with suitable connection technology for your product.

Suitable mounting technology no.	Cutting/locking ring: 907 908
	M18×1 sealing cone: 900 901

Suitable connection technology no. 2

S02

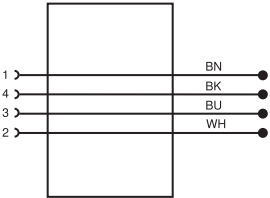

3.7 Layout

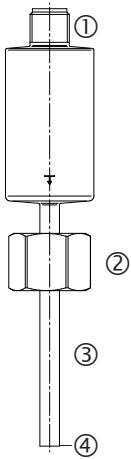

- ① = plug connector
- ② = process connection
- ③ = sensor rod
- ④ = measuring probe

3.8 Scope of Delivery

- FXFF1xx Flow Sensor
- Quick-start guide

4. Transport and Storage

4.1 Transport

Upon receipt of shipment, inspect the goods for damage in transit. In the case of damage, conditionally accept the package and notify the manufacturer of the damage. Then return the device, making reference to damage in transit.

4.2 Storage

The following points must be taken into condition with regard to storage:

- Do not store the product outdoors.
- Store the product in a dry, dust-free place.
- Protect the product against mechanical impacts.



ATTENTION!

Risk of property damage in case of improper storage!

The product may be damaged.

- Comply with storage instructions.
-

5. Installation and Electrical Connection

5.1 System Overview



Connector Cables

ZCCL001 (straight, PVC, IP69K) 10 m

S23-2M (straight, PVC) 2 m

S23-2MPUR (straight, PUR) 2 m

S23-5M (straight, PVC) 5 m

S23-5MPUR (straight, PUR) 5 m

S23-10M (straight, PVC) 10 m

S23-10MPUR (straight, PUR) 10 m

S29-2M (angled, PVC) 2 m

S29-5M (angled, PVC) 5 m

S29-5MPUR (angled, PUR) 5 m

S29-10M (angled, PVC) 10 m

Adapters

... for cutting/locking ring

Cutting ring fitting: ZH6C001, ZH6C002, ZH6C005, ZH6C006

Locking ring fitting: ZH6C003, ZH6C004

Sealing ring: ZH5G001, ZH5G002

... for sealing cone, M18×1

G ¼": ZH1C001, ZH1C008

G ½": ZH1C002, ZH1C003, ZH1C007

G 1": ZH1C009

NPT: ZH1C004, ZH1C005

Welding fitting: ZH4C004, ZH4C005



NOTE!

Further accessories and mounting technology (e.g. t fittings, weld-in adapters, ...) are available on the relevant product detail page at www.wenglor.com.

5.2 Installation

- Protect the product from contamination during installation.
- Observe all applicable electrical and mechanical regulations, standards, and safety rules.
- Protect the product against mechanical influences.
- Make sure that the sensor is mounted in a mechanically secure fashion.
- Specified torque values must be complied with (see “3. Technical Data” on page 8).

Mounting

Conditions for correct detection of the flow rate:

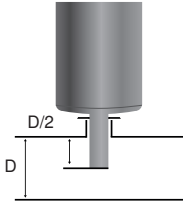
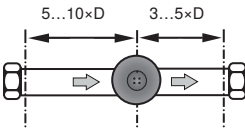
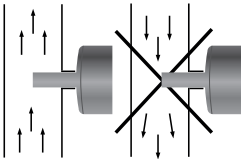
<p>In order to correctly detect the flow rate, the tip of the sensor is positioned ideally in the middle of the pipe.</p>	
<p>Adequate distance from pipe bends and points at which cross-sections change must be maintained in order to correctly detect the flow rate. The specified distances are minimum distances. The specified values may vary depending on the type of disturbing influence.</p>	
<p>Install sensors in closed systems and riser pipes because detection of the flow rate is faulty in pipes which are open at the bottom.</p>	



ATTENTION!

Risk of property damage in case of improper installation!

The product may be damaged.

- Comply with installation instructions.



CAUTION!

Risk of personal injury or property damage during installation!

Personal injury and damage to the product may occur.

- Ensure a safe installation environment.

5.3 Installation Instructions for Devices with EHEDG Certification

Sensors with an "EHEDG Certified" label (see technical data for the respective sensor) are suitable for CIP applications and do not have to be removed for cleaning. The following instructions must be adhered to in order to comply with EHEDG certification:

- The product may only be mounted to suitable equipment which complies with EHEDG guidelines.
- The product must be installed such that there is no dead space.
- The equipment must be set up such that the system can subsequently still be entirely emptied.
- If mounted to a T-fitting, the necking may not be longer than the inside diameter of it minus the sensor probe diameter: $L < (D - d)$.

– Example:

Diameter necking $D = 20 \text{ mm}$

Diameter sensor probe $d = 6 \text{ mm}$

Length $L < 20 - 6 \text{ mm} \Rightarrow L < 14 \text{ mm}$

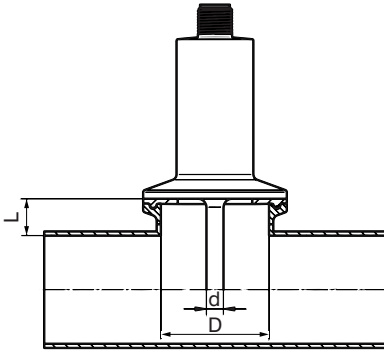

- If the product is mounted to a tank, the cleaning device must be installed so that it directly flushes the connection/dead space.
- Only suitable seals may be used which comply with EHEDG guidelines. In particular in the case of fittings in accordance with DIN 11851 (dairy pipe fittings) and DIN 32676 (clamp connections), the seal must be chosen according to the EHEDG Position Paper on easy cleanable pipe couplings and process connections. Suitable seals can be purchased from a specialist retailer.
- Varivent connection:
 - Restriction type F: Installation only permitted in tank mounting flanges
 - Type N: Installation in tank mounting flanges and pipelines

5.4 Electrical Connection

- Connect the sensor to 12 to 32 V DC (see “3.5 Wiring Diagram” on page 12)



DANGER!

Risk of personal injury or property damage due to electric current!

Voltage conducting parts may cause personal injury or damage to equipment.

- The electric device may only be connected by appropriately qualified personnel.
-

5.5 Diagnostics

Required action in case of fault:



NOTE!

- Shut down the machine.
 - If the error cannot be eliminated, please contact wenglor's support department.
 - Do not operate in case of indeterminate malfunctioning.
 - The machine must be shut down if the error cannot be unequivocally clarified or reliably eliminated.
-



DANGER!

Risk of personal injury or property damage in case of non-compliance!

The system's safety function is disabled. Personal injury and damage to equipment.

- Required action as specified in case of fault.
-

6. Cleaning

- Sensors with an “EHEDG Certified” label are suitable for CIP applications and do not have to be removed for cleaning.
- Permissible ambient temperature and degree of protection must be observed when cleaning from the outside.
- When selecting a cleaning agent, the degree of resistance demonstrated by the materials must be taken into consideration. A resistance table can be downloaded from wenglor.com.

7. Maintenance Instructions

NOTE!



- This wenglor sensor is maintenance-free.
 - Cleaning and inspection of the plug connections at regular intervals is advisable.
 - Do not clean the sensor with solvents or cleansers which could damage the product.
 - The product must be protected against contamination during initial start-up.
 - Contamination which adheres to the measuring probe distorts the measured value for flow rate.
-

8. Returns

Due to legal regulations and for the protection of employees, wenglor sensoric GmbH requires a signed declaration of decontamination before your order can be processed.

The corresponding form is available at www.wenglor.com → Download → General Terms and Conditions and Returns.

9. Proper Disposal

wenglor sensoric GmbH does not accept the return of unusable or irreparable products. Respectively valid national waste disposal regulations apply to product disposal.

10. Appendix

10.1 Change Index, Operating Instructions

Version	Date	Description/Change
1.0.0	08.07.2016	Initial version of the operating instructions
1.0.1	19.10.2016	Changes to the "Technical Data"
1.1.0	27.10.2016	Expansion of the connection cables in the system overview
1.2.0	11.05.2017	Changes to the "Technical Data"
1.3.0	16.07.2018	Changes to the "Technical Data", Overview update
1.4.0	04.12.2018	Expansion of the manual with " 3.1 Default Settings "
1.5.0	09.07.2019	Response Time in "Technical Data"
1.6.0	01.09.2020	Update " 3. Technical Data " on page 8 Expansion of the manual with " 5.3 Installation Instructions for Devices with EHEDG Certification " on page 17 and " 6. Cleaning " on page 18
1.7.0	30.06.2022	Update " 3. Technical Data " on page 8

10.2 EU Declaration of Conformity

The EU declaration of conformity can be found on our website at www.wenglor.com in the product's separate download area.