

Glass Fiber-Optic Cable

Reflex Mode for P1XF

FL30/50

Part Number



Technical Data

Optical Data

Fiber Bundle Diameter	2,3 mm
Range	0...50 mm
Opening Angle	68 °
Fiber Distribution	separate fiber bundles

Mechanical Data

Temperature Range	-25...180 °C
Fiber-Optic Length	5 cm

Fiber-Optic Cable Adapter No.

001

- Compatible with the P1XF001 6-channel Multispectral Sensor
- Laid out for tight installation spaces
- Rugged design

In the scanning mode, the glass fiber-optic cables are compatible with the P1XF001 6-channel Multispectral Sensor. They're ideal for use in difficult to access locations and they detect colored objects.



FL30/50

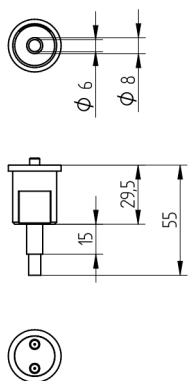

All dimensions in mm (1 mm = 0.03937 Inch)

